

D. 23. 1773

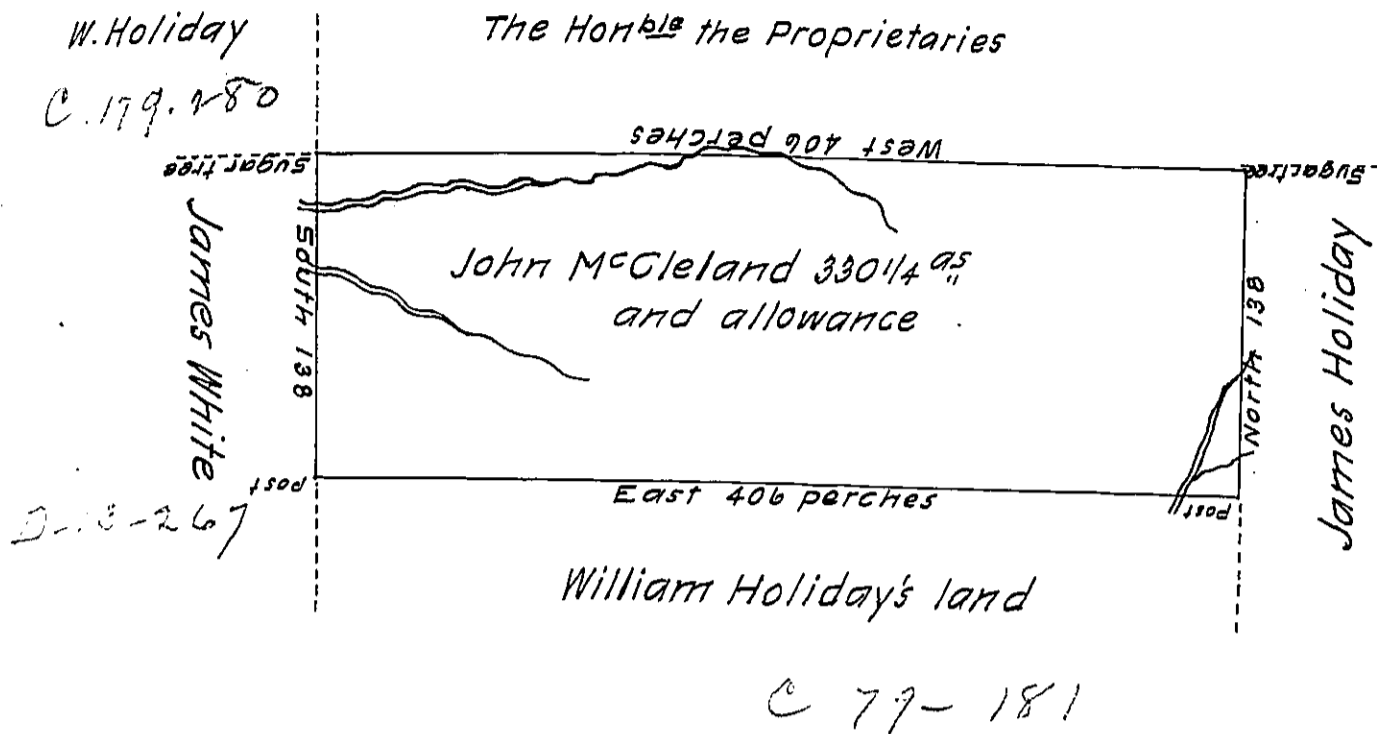

C 77-181

A draught of a tract of land called Holiday's Choice situate on the waters of Clearfield & Chest. Creek adjoining & South of the Honorable the Proprietaries Chest. Manor East of James White's land North of William Holiday's land & West of James Holliday's land in the County of Bedford containing three hundred & thirty acres & the usual allowance of six pr cent for roads &c. surveyed the 14th day of September 1773 for John McClelland in pursuance of a warrant dated the 23^d day of July the same year, by

Thomas Smith D.S.

To John Lukens Esq^t }
 Surveyor General &c }

IN TESTIMONY that the above is a copy of the original remaining on file in the Department of Internal Affairs of Pennsylvania, made conformably to an Act of Assembly approved the 16th day of February, 1833, I have hereunto set my Hand and caused the Seal of said Department to be affixed at Harrisburg, this twenty-third day of May 1912

Henry Horck
 Secretary of Internal Affairs.